

TECHNICAL SPECIFICATIONS

MODELS WITH BUILT-IN RECTIFIERS (115 V.A.C. SINGLE PHASE, 60HZ)

SIZE (DIA.)	B	C	D	E	F	G	APPROX. NET WEIGHT (LBS.)
7"	8 1/16	4 7/16	2 1/4	1 1/2	1 1/4	3/8	38
10"	9 5/8	4 5/8	2 7/8	1 3/4	1 1/2	1/2	87
12"	10 1/8	4 3/4	2 7/8	1 3/4	1 1/2	1/2	120
15"	10	5 1/4	3 3/4	1 3/4	1 1/2	1/2	235

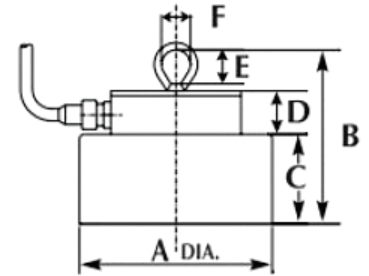

MODELS OPERATING ON STANDARD D.C. VOLTAGE [115V.D.C. EXCEPT 4" (12 V.D.C.)]

SIZE (DIA.)	A	B	C	D	E	WATTS INTERMITTENT	APPROX. NET WEIGHT (LBS.)
4"	4	5 1/2	3 5/8	1 3/16	7/16	40	11
7"	7	5 27/32	4 7/16	1 3/16	7/16	114	34
10"	10	6 7/16	4 5/8	1 1/2	2 1/32	201	78
12"	12	6 7/16	4 3/4	1 1/2	2 1/32	261	112
15"	15	7 7/16	5 1/4	1 1/2	2 1/32	392	212

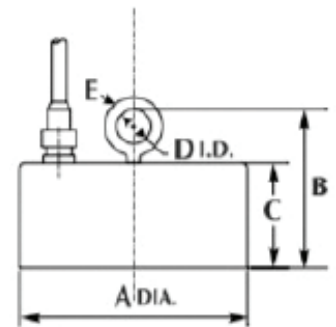

PULL DATA

SIZE (O.D)	4"	7"	10"	12"	15"
MAX. FORCE (COLD) LB. THEORETICAL	612	2,380	5,675	6,950	11,150
MAX. FORCE HOT 75% THEORETICA	344	1,740	3,290	3,900	6,290
MIN. PLATE THICKNESS (ZERO AIR GAP DIRECT CONTACT MAX. FORCE)	3/4"	1"	1 1/4"	1 1/2"	1 3/4"

OHIO MAGNETICS, INC.
 5400 DUNHAM RD | MAPLE HEIGHTS, OH | 44317-3687
 TEL: (216) 662-8484 | sales@ohiomagnetics.com
 © 2022 OHIO MAGNETICS, INC.

Made in U.S.A.